

AGENDA

RAYTOWN PARKS & RECREATION BOARD

**Monday, March 20, 2017
Park Office, 5912 Lane, Raytown
7:00 PM**

I. Call to Order

II. Public Participation

Approval of Minutes – February 20, 2017 Regular Meeting

III. Reports of Officers

President – Terry Copeland

Vice President – Danielle Miles

IV. Reports of Standing & Special Committees

Personnel – Nancy Nail

Finance – Chris Rathbone

Program – Danielle Miles

Buildings & Grounds – Mike Hanna

V. Staff Reports

Director – Kevin Boji

Superintendent of Parks - Ron Fowler

Recreation Report - Dave Turner

VI. New Business

1. Sales Tax Report-Super Splash
2. Kenagy fountain update
3. Other Business

VII. Adjourn

VIII. Announcements

- Next Meeting: Monday, April 17, 2017 7 PM Park Office



City of Raytown, MO

Fund Balance Report

As Of 03/08/2017

Fund	Beginning Balance	Total Revenues	Total Expenses	Ending Balance
201 - PARKS & RECREATION	739,965.05	621,560.31	281,068.77	1,080,456.59
Report Total:	739,965.05	621,560.31	281,068.77	1,080,456.59



Budget Report

Account Summary

For Fiscal: 2016-2017 Period Ending: 03/31/2017

		Original Total Budget	Current Total Budget	Period Activity	Fiscal Activity	Variance Favorable (Unfavorable)	Percent Remaining
Fund: 201 - PARKS & RECREATION							
Revenue							
201-00-00-001-41206	TIF - EATS	-57,750.00	-57,750.00	0.00	-19,437.96	38,312.04	33.66 %
201-00-00-100-41205	Parks/Storm Water Capital Sales Ta	307,500.00	307,500.00	0.00	125,670.65	-181,829.35	59.13 %
201-00-00-100-46102	Investment Income	0.00	0.00	0.00	678.70	678.70	0.00 %
201-92-00-100-41101	Real Estate Tax	430,000.00	430,000.00	0.00	384,442.95	-45,557.05	10.59 %
201-92-00-100-41102	Personal Property Tax	108,000.00	108,000.00	0.00	81,999.21	-26,000.79	24.07 %
201-92-00-100-41104	Delinquent Real Estate Taxes	12,000.00	12,000.00	0.00	5,362.21	-6,637.79	55.51 %
201-92-00-100-41105	Penalties	8,000.00	8,000.00	0.00	2,369.70	-5,630.30	70.38 %
201-92-00-100-41107	Railroad & Utilities Tax	20,000.00	20,000.00	0.00	0.00	-20,000.00	100.00 %
201-92-00-100-41108	Replacement Tax	22,500.00	22,500.00	0.00	19,012.66	-3,487.34	15.50 %
201-92-00-100-41110	Circuit Breaker Refund	-3,000.00	-3,000.00	-235.62	-1,074.40	1,925.60	35.81 %
201-92-00-100-41111	Delinquent Tax Revenue	8,000.00	8,000.00	0.00	4,003.31	-3,996.69	49.96 %
201-92-00-100-46101	Interest Earnings	0.00	0.00	0.00	544.29	544.29	0.00 %
201-92-00-100-47116	Vending Machine-Kenagy	900.00	1,650.00	0.00	34.00	-1,616.00	97.94 %
201-92-00-100-47220	Donations	500.00	500.00	0.00	0.00	-500.00	100.00 %
201-92-00-100-47525	General Donations	0.00	0.00	0.00	1,471.68	1,471.68	0.00 %
201-92-00-100-47530	Rice Tremonti	6,900.00	6,900.00	579.36	2,896.80	-4,003.20	58.02 %
201-93-00-100-47101	Ballfield Lights Fees	5,000.00	5,000.00	0.00	-15.00	-5,015.00	100.30 %
201-93-00-100-47105	Shelter House Rental Fees	15,500.00	15,500.00	540.00	8,255.00	-7,245.00	46.74 %
201-93-00-100-47110	Sports Field Rental Fees	1,500.00	1,500.00	0.00	896.00	-604.00	40.27 %
201-93-00-100-47204	Team Sports League	56,000.00	56,000.00	0.00	3,315.00	-52,685.00	94.08 %
201-94-00-100-47510	Trees for Raytown	200.00	200.00	0.00	0.00	-200.00	100.00 %
201-94-00-902-47116	Vending Machine-Kenagy	750.00	0.00	0.00	0.00	0.00	0.00 %
201-95-00-100-47401	Participant Fees	24,000.00	24,000.00	0.00	869.00	-23,131.00	96.38 %
201-95-00-100-47405	Concession Sales	5,250.00	5,250.00	0.00	76.51	-5,173.49	98.54 %
201-95-00-100-47415	ABA Memberships	3,500.00	3,500.00	0.00	190.00	-3,310.00	94.57 %
201-95-00-100-47425	Other Income	200.00	200.00	0.00	0.00	-200.00	100.00 %
Revenue Total:		975,450.00	975,450.00	883.74	621,560.31	-353,889.69	36.28 %
Expense							
201-00-00-000-59941	CASH LONG & SHORT	0.00	0.00	0.00	40.00	-40.00	0.00 %
201-91-00-100-52250	Professional Services	2,000.00	2,000.00	0.00	105.00	1,895.00	94.75 %
201-91-00-100-52750	Building Maintenance	7,300.00	7,300.00	0.00	433.42	6,866.58	94.06 %
201-91-00-100-53250	Capital Expenditures	0.00	70.62	0.00	70.62	0.00	0.00 %
201-91-00-100-53500	Equipment Expense	6,000.00	6,000.00	0.00	879.37	5,120.63	85.34 %
201-91-00-100-53750	General Supplies	200.00	200.00	0.00	0.00	200.00	100.00 %
201-91-00-100-54750	Utilities	9,500.00	9,500.00	0.00	1,313.94	8,186.06	86.17 %
201-92-00-100-51102	Civilian Employees	128,338.00	128,338.00	0.00	44,419.49	83,918.51	65.39 %
201-92-00-100-51111	Civilian Employees Overtime	1,000.00	1,000.00	0.00	312.62	687.38	68.74 %
201-92-00-100-52250	Professional Services	57,152.00	57,152.00	0.00	29,159.14	27,992.86	48.98 %
201-92-00-100-52500	Printing & Promotions	525.00	525.00	0.00	0.00	525.00	100.00 %
201-92-00-100-53250	Capital Expenditures	40,000.00	40,000.00	0.00	0.00	40,000.00	100.00 %
201-92-00-100-53500	Equipment Expense	4,900.00	4,900.00	0.00	259.27	4,640.73	94.71 %
201-92-00-100-53750	General Supplies	2,075.00	2,075.00	0.00	49.62	2,025.38	97.61 %
201-92-00-100-54750	Utilities	9,580.00	9,630.00	0.00	1,372.41	8,257.59	85.75 %
201-92-00-100-55500	Professional Development	3,070.00	3,070.00	0.00	360.00	2,710.00	88.27 %
201-92-00-100-59000	Employee Benefits	55,996.00	55,996.00	0.00	22,980.09	33,015.91	58.96 %
201-93-00-100-51102	Civilian Employees	47,800.00	47,800.00	0.00	16,268.38	31,531.62	65.97 %
201-93-00-100-51106	Part Time Employees	7,650.00	7,650.00	0.00	0.00	7,650.00	100.00 %
201-93-00-100-52500	Printing & Promotions	100.00	100.00	0.00	0.00	100.00	100.00 %
201-93-00-100-53250	Capital Expenditures	1,000.00	1,000.00	0.00	0.00	1,000.00	100.00 %
201-93-00-100-54500	Recreational Programming	52,450.00	52,477.00	2,742.84	12,493.34	39,983.66	76.19 %

Budget Report

For Fiscal: 2016-2017 Period Ending: 03/31/2017

		Original Total Budget	Current Total Budget	Period Activity	Fiscal Activity	Variance Favorable (Unfavorable)	Percent Remaining
<u>201-93-00-100-54750</u>	Utilities	4,500.00	4,500.00	0.00	1,165.33	3,334.67	74.10 %
<u>201-93-00-100-55500</u>	Professional Development	250.00	250.00	0.00	125.00	125.00	50.00 %
<u>201-93-00-100-59000</u>	Employee Benefits	17,433.00	17,433.00	0.00	6,221.58	11,211.42	64.31 %
<u>201-94-00-100-51102</u>	Civilian Employees	250,338.00	250,338.00	0.00	76,248.81	174,089.19	69.54 %
<u>201-94-00-100-51106</u>	Part Time Employees	7,650.00	7,650.00	0.00	1,437.20	6,212.80	81.21 %
<u>201-94-00-100-51111</u>	Civilian Employees Overtime	500.00	500.00	0.00	455.35	44.65	8.93 %
<u>201-94-00-100-52250</u>	Professional Services	46,822.00	46,831.00	0.00	9,330.81	37,500.19	80.08 %
<u>201-94-00-100-52500</u>	Printing & Promotions	600.00	600.00	0.00	0.00	600.00	100.00 %
<u>201-94-00-100-52750</u>	Building Maintenance	43,700.00	44,027.71	1,731.75	5,414.85	38,612.86	87.70 %
<u>201-94-00-100-53250</u>	Capital Expenditures	50,000.00	50,000.00	0.00	0.00	50,000.00	100.00 %
<u>201-94-00-100-53500</u>	Equipment Expense	18,900.00	18,910.48	192.00	1,400.53	17,509.95	92.59 %
<u>201-94-00-100-53750</u>	General Supplies	2,800.00	2,980.10	54.00	311.36	2,668.74	89.55 %
<u>201-94-00-100-54000</u>	Office Supplies	1,200.00	1,200.00	0.00	225.00	975.00	81.25 %
<u>201-94-00-100-54750</u>	Utilities	56,100.00	56,100.00	370.38	6,802.47	49,297.53	87.87 %
<u>201-94-00-100-55000</u>	Vehicle Expense	19,500.00	20,245.86	0.00	2,999.71	17,246.15	85.18 %
<u>201-94-00-100-55250</u>	Uniforms	2,900.00	3,133.88	0.00	492.88	2,641.00	84.27 %
<u>201-94-00-100-55500</u>	Professional Development	4,200.00	4,200.00	0.00	867.25	3,332.75	79.35 %
<u>201-94-00-100-59000</u>	Employee Benefits	111,402.00	111,402.00	0.00	34,054.10	77,347.90	69.43 %
<u>201-95-00-100-52250</u>	Professional Services	11,000.00	11,113.00	0.00	1,632.53	9,480.47	85.31 %
<u>201-95-00-100-52500</u>	Printing & Promotions	6,200.00	6,483.00	0.00	706.50	5,776.50	89.10 %
<u>201-95-00-100-52750</u>	Building Maintenance	4,500.00	4,500.00	0.00	0.00	4,500.00	100.00 %
<u>201-95-00-100-53500</u>	Equipment Expense	600.00	600.00	0.00	0.00	600.00	100.00 %
<u>201-95-00-100-53750</u>	General Supplies	4,900.00	5,020.48	0.00	120.48	4,900.00	97.60 %
<u>201-95-00-100-54000</u>	Office Supplies	250.00	250.00	0.00	0.00	250.00	100.00 %
<u>201-95-00-100-54750</u>	Utilities	4,300.00	4,300.00	0.00	512.83	3,787.17	88.07 %
<u>201-95-00-100-55000</u>	Vehicle Expense	1,000.00	1,000.00	0.00	27.49	972.51	97.25 %
Expense Total:		1,108,181.00	1,110,352.13	5,090.97	281,068.77	829,283.36	74.69 %
Fund: 201 - PARKS & RECREATION Surplus (Deficit):		-132,731.00	-134,902.13	-4,207.23	340,491.54	475,393.67	352.40 %
Report Surplus (Deficit):		-132,731.00	-134,902.13	-4,207.23	340,491.54	475,393.67	352.40 %

Parks & Recreation Dept. Activity Report

Date: 3-10-17



- At Kenagy Park, a new 4' x 45' concrete walk path from the park shelter to the restroom facility was installed by parks staff. A second ADA compliant shelter access ramp is located to the west.
- A new bike/walk trail is coming to the area for residents to enjoy. Construction continues this spring on the Little Blue Trace Park 10' wide concrete connector trail at 87th & 350 Hwy. Kansas City Parks and Recreation Dept is the project manager.
- Repairs to the "Welcome to Raytown" signs at entrances to the city are complete.
- Horticulturalist Brian Schyvinck and Landscape Technician Garrett Baxter continue with brush removal and tree trimming in right of way (ROW) and traffic islands due to mild temperatures.
- Staff met with members of the Raytown BMX Board of Directors last week to discuss track operations. On a related matter, a Board of Alderman BMX budget amendment is on the March 21 meeting agenda. The budget amendment was approved by the Park Board on February 20. BMX is evaluating whether to continue to operate under the city or to seek 501c3 non-profit status to operate independently.
- Park shelters available for rent remain 90-95% booked for both Saturdays and Sundays throughout the summer months and providing revenue to the department.
- Small equipment maintenance for the spring mowing season continues with battery replacement, oil changes, belt replacement and other routine maintenance work is ongoing.
- Staff is meeting with key sponsors for the Raytown Arts & Music Festival including Dick Smith Ford and Vance Brothers. These local firms have been key sponsors of the event. The Raytown connection to Brewer & Shipley continues this year. The duo is scheduled to return to Raytown for the third time in celebration of their 50th anniversary.
- Bark in the Park, an event just for dogs is scheduled for Saturday, May 10, 2017 at Kenagy Park. Park staff attends meetings and assist with coordinating the event in partnership with Raytown First Baptist Church.
- Planning and scheduling spring programs are underway for adult softball leagues, 50+ softball, sports field rentals, and youth and adult tennis instructional programs.
- Plan capital improvement projects including chip seal bid with Public Works and park shop siding replacement



Line Items

2017 GRANITE SEAL PROJECT

DATE BID: Friday, May 20, 2016 at 2:00PM

				Vance Brothers	
Item Description		Est. Qty.	Units	Unit Price	Est. Amount
1.	Granite Chip Seal - Patching	0	S.Y.	\$2.05	\$0.00
2.	Granite Chip Seal - Final Surface	279,053	S.Y.	\$1.85	\$516,248.05
3.	Minor Smith Park - Trail Asphalt Wedging	88.89	S.Y.	\$21.25	\$1,888.89
4.	Minor Smith Park - Trail 1/8" Haydite Chip Seal	2,388.4	S.Y.	\$5.35	\$12,778.18

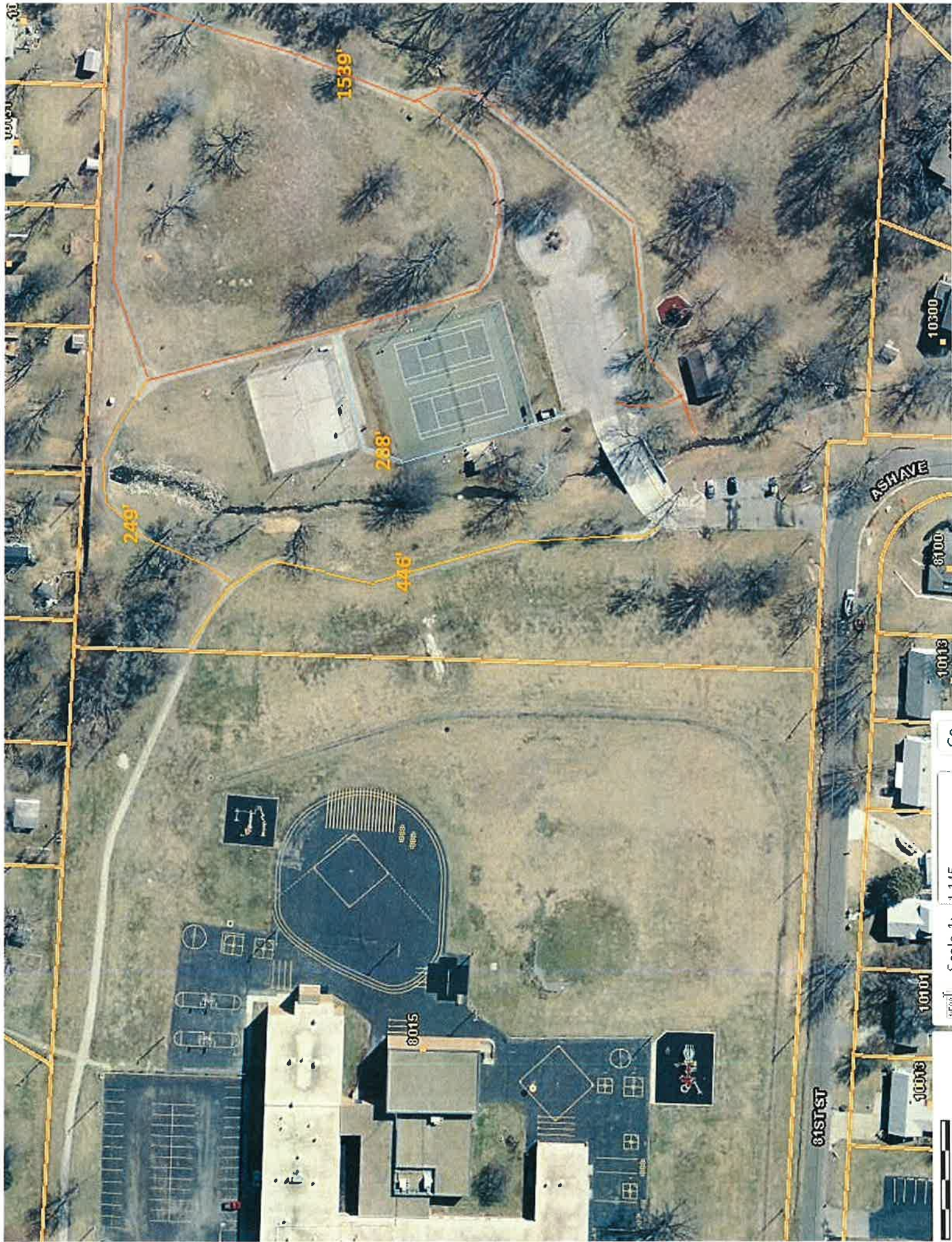

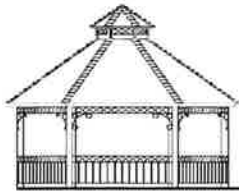

poligon®

PARK ARCHITECTURE

Recreation Resource, Inc.
913-814-7082
johnnymac1205@gmail.com

3-03-17

Mr. Kevin Boji
City of Raytown, MO.
10000 E. 59th Street
Raytown, MO. 64133
816-358-4100
kevin@raytownparks.com

Qty: 1	Poligon REK 30' x 44 MR	\$ 30,860.00
	NJPA Discount	- \$ 4,629.00
		\$ 26,231.00
	Eng. Stamp, State of MO.	\$ 250.00
	Freight	\$ 1,450.00
	Total Delivered	\$ 27,931.00

Optional Install (No Footings) \$ 13,900.00

- Powder Coated Metal Frame, Standard Color
- Multi Rib Metal Roof, Standard Color
- Anchor Bolts shipped in advance
- Freight
- Engineering Stamp, State of Missouri
- Make purchase orders to "Portercorp"

John McMaster
W.H. Porter/Portercorp

Poligon Product Specification Form

by **PORTERCORP**
 1 FORBESCONE 1240 N 136th AVE HOLLAND MI 49424
 www.poligon.com 800-354-7721

PROJECT NAME: _____
 PROJECT LOCATION: _____
 CUSTOMER NAME: _____
 E-MAIL: _____
 COMPANY: _____
 ADDRESS: _____
 ADDRESS 2: _____
 CITY: _____
 STATE: _____ ZIP: _____
 PHONE: _____ FAX: _____
 WIND LOAD: _____ SNOW LOAD: _____
 SEISMIC DESIGN: _____ BLDG CODE: _____

Shelter Options

SELECT APPLICABLE ROOF TYPE:

☐ MR (Metal Roof)
☐ SPWR (Structural Panel under Metal Roof)
☐ TGMK (Tongue & Groove under Metal Roof)
☐ SS (Standing Seam Roof)
☐ SPSS (Structural Panel under Standing Seam)
☐ TGS (Tongue & Groove under Standing Seam)
☐ SPAS (Structural Panel under Asphalt Shingles)
☐ SPCS (Structural Panel under Cedar Shingles)
☐ SPCH (Structural Panel under Milled Cedar Shingles)
☐ TGA (Tongue & Groove under Asphalt Shingles)
☐ TGC (Tongue & Groove under Cedar Shingles)
☐ TGC (Tongue & Groove under Milled Cedar Shingles)
☐ LATIA (Santa Fe metal stick style)
☐ TRELLIS

SELECT MODIFICATIONS TO A STANDARD:

☐ INCREASE UPB HEIGHT:
☐ ADD ELECTRICAL CUTOUTS:
☐ ADD CUPOLA:
☐ ADD ORNAMENTATION:
☐ ADD BENCHES:
☐ ADD HANDRAILS:

SELECT CUSTOMIZATION:

☐ INCREASE UPB MORE THAN 2":
☐ CUSTOM COLUMNS:
☐ CUSTOM PITCH:
☐ ADD E-COATING FRAME:
☐ ADD GALVANIZING FRAME:

FRAME COLOR: _____
 ROOF COLOR: _____

Sheet Index

COVER SHEET / ORDER FORM
 ELEVATION VIEWS
 STRUCTURAL FRAME
 ANCHOR LAYOUT

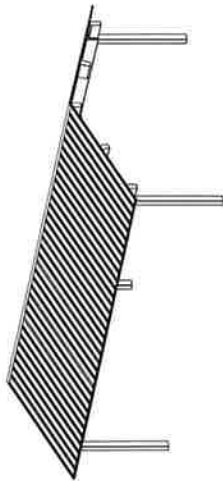

Rectangle Standard Sizes

BIN	W	L	BAY SIZE
REK	8	9	7
REK	8	16	14
REK	8	24	22
REK	16	24	20
REK	16	34	30
REK	16	44	20
REK	20	24	20
REK	20	34	30
REK	20	44	20
REK	24	34	30
REK	24	44	20
REK	24	64	20

BIN	W	L	BAY SIZE
REK	24	84	20
REK	30	34	30
REK	30	44	20
REK	30	64	20
REK	30	84	20
REK	30	104	20
REK	40	44	20
REK	40	64	20
REK	40	84	20
REK	40	104	20
REK	50	64	20
REK	50	84	20
REK	50	104	20

Refer to www.poligon.com download area for:

- FOOTING AND ANCHOR INFORMATION
- COLUMN STYLE OPTIONS
- CUPOLA OPTIONS
- ORNAMENTATION STYLE OPTIONS
- INTEGRATED BENCH OPTIONS
- MISCELLANEOUS OPTIONS
- COLOR CHARTS

PORTERCORP MANUFACTURES AND DELIVERS PRODUCT IN STRICT COMPLIANCE TO GOVERNING BUILDING CODES.

SHELTER MODEL RECTANGLE REK

SCALE: 1"=8'0" REV LEVEL: A DATE: 2/9/2011

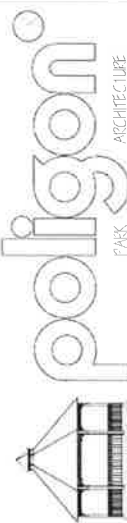

Designs and calculations of Poligon buildings are protected under copyright laws and patents and may not be used in the construction or design of a building that is not supplied by Poligon.

by **PORTERCORP**
 PORTERCORP 4240 N 136th AVE HOLLAND MI 49424
 www.poligon.com 800-354-7721

COVER SHEET

NOTE: THIS IS A

PLANNING LEVEL DRAWING.

THE STRUCTURE SHOWN IS SUBJECT TO ON-GOING DESIGN REVIEW AND UPDATE. EXPECT SOME CHANGES TO MATERIAL SIZES AND GENERAL DIMENSIONS. ONLY USE DRAWINGS PROVIDED WITH ENGINEERED STRUCTURES FOR CONSTRUCTION.

- SEE FINISHES / ROOFING PAGE FOR:
- FRAME FINISH OPTIONS
 - POWDER COAT AND ROOFING COLOR SELECTION
 - TONGUE & GROOVE
 - STRUCTURAL INSULATED PANEL AND METAL ROOF OPTIONS
 - OTHER ROOFING OPTIONS

- SEE ORNAMENTATION PAGE FOR:
- ORNAMENTATION PATTERNS
 - RAILING PATTERNS
 - COLUMN OPTIONS
 - CUPOLA OPTIONS

THIS SHELTER PROVIDES 1,320 SQ. FT. OF SHADE.

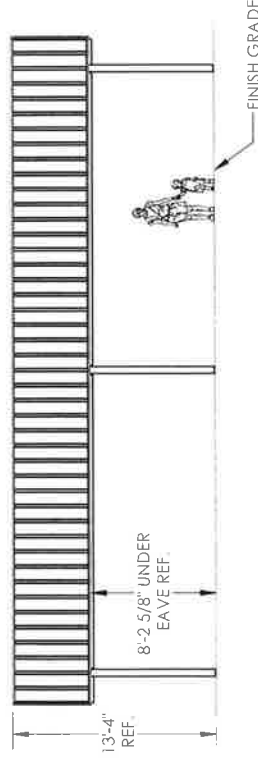
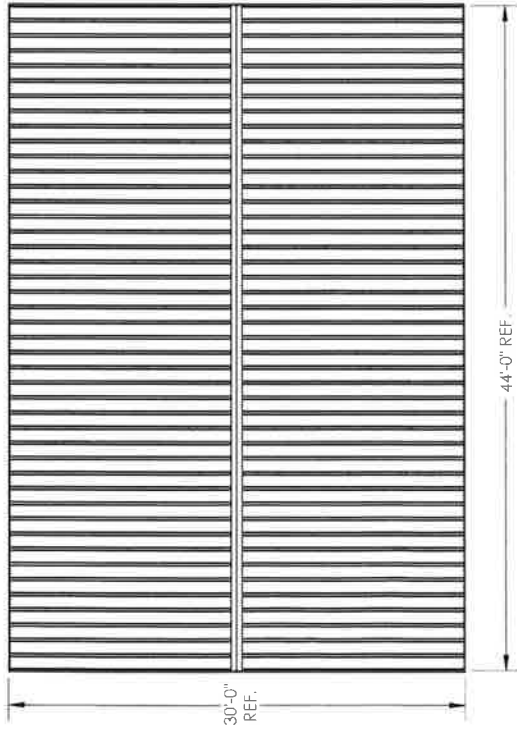
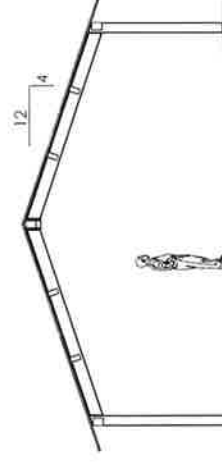
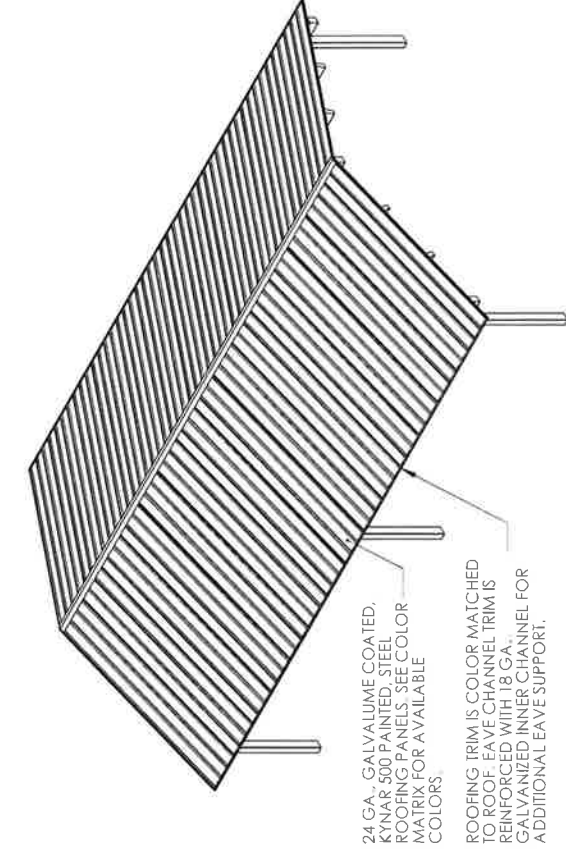

24' AND 34' (20' BAY LENGTHS) ARE STANDARD SHELTER LENGTHS FOR SINGLE BAY UNITS. 20' IS THE STANDARD BAY LENGTH FOR MULTIPLE BAY INSTALLATIONS. CUSTOM SHELTER LENGTHS TO SUIT SITE AND USE REQUIREMENTS ARE ALSO AVAILABLE.

SHELTER MODEL:
**RECTANGLE 30X44
REK-30**

SCALE	REVISED	DATE
1/8" = 1'-0"	A	2/3/2011

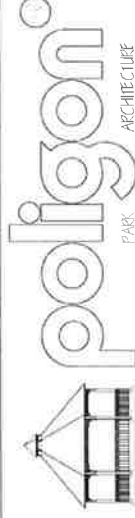

Designs and calculations of Poligon buildings are protected under copyright laws and patents and may not be used in the construction or design of a building that is not supplied by Poligon.

by **PORTERCORP**

PORTERCORP 4240 N. 158TH AVE. HOLLAND, MI 48034

www.poligon.com 800-354-7721

ELEVATION VIEWS

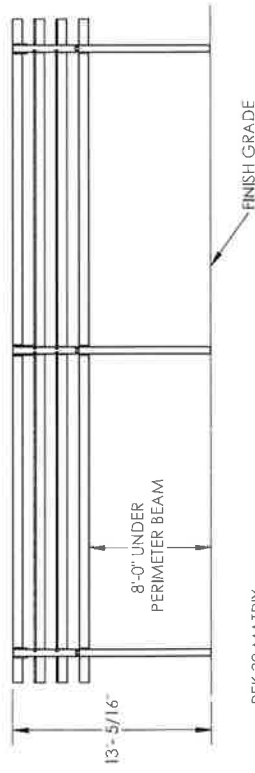
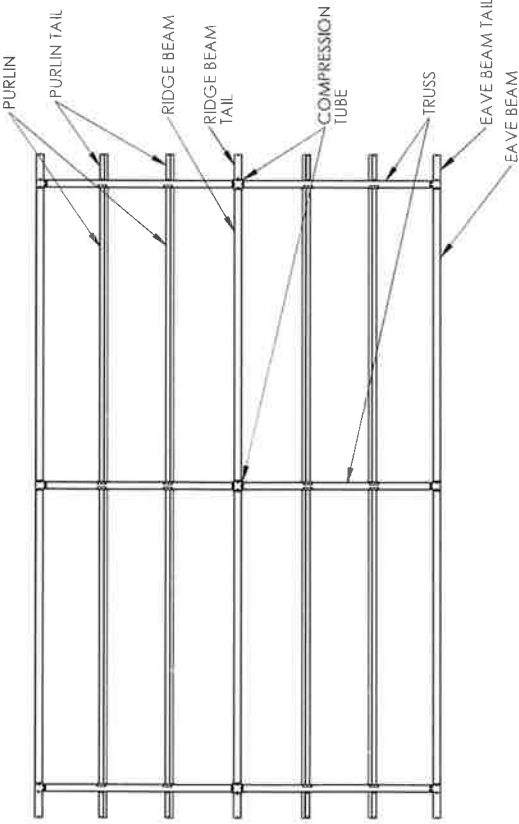

- REK 30 MATRIX:
- 30X34 20' BAY
 - 30X44 20' BAYS
 - 30X64 20' BAYS
 - 30X84 20' BAYS
 - 30X104 20' BAYS

REKS ARE AVAILABLE IN SINGLE OR MULTIPLE BAY LENGTHS.

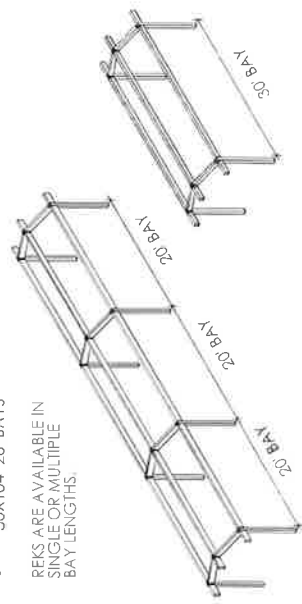

NOTE: THIS IS A

PLANNING LEVEL DRAWING.

THE STRUCTURE SHOWN IS SUBJECT TO ONGOING DESIGN REVIEW AND UPDATES. EXPECT SOME CHANGES TO MATERIAL SIZES AND GENERAL DIMENSIONS. ONLY USE DRAWINGS PROVIDED WITH ENGINEERED STRUCTURES FOR CONSTRUCTION.

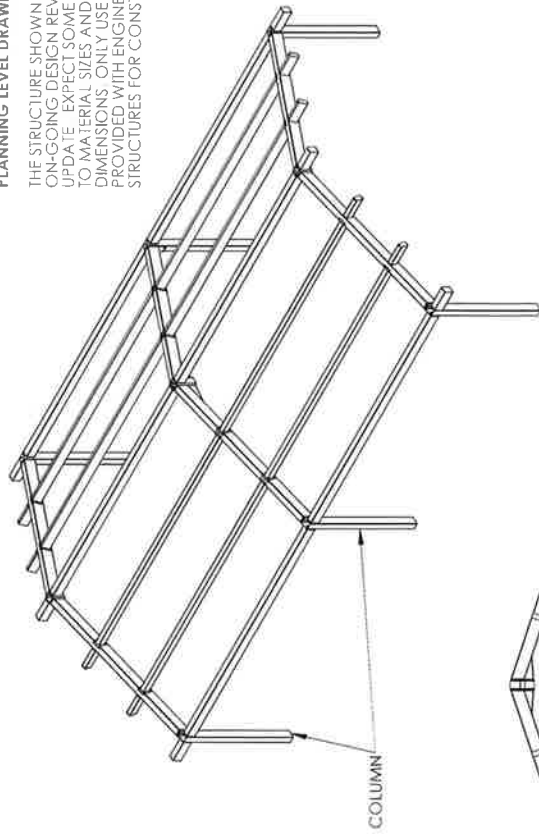

FRAME AND ORNAMENTATION FINISH:
MEMBERS SHOT-BLASTED TO NEAR WHITE CONDITION (SSPG SP-10), WASHED AND SEALED IN A PHOSPHATE SPRAY, COATED WITH SUPER DURABLE TGIC POLYESTER POWDER AND OVEN CURED.

SEE COLOR MATRIX FOR AVAILABLE COLORS.

OPTIONAL UNDERCOAT:
EPOXY E-COAT SYSTEM, USING FULL IMMERSION ELECTRO-DEPOSITION PROCESS.

SCALE	REVISION	DATE
1/8" = 1'-0"	A	2/9/2011

SHELTER MODEL:
RECTANGLE 30X44
REK-30X44

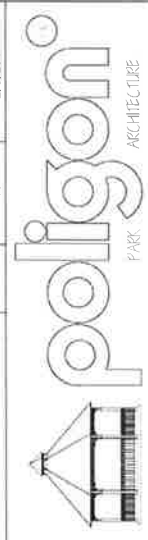

Designs and calculations of Poligon buildings are protected under copyright laws and patents and may not be used in the construction or design of a building that is not supplied by Poligon.

by **PORTERCORP**
PORTERCORP 4240 N 138th AVE TOLAND MI 49451
www.poligon.com 800-354-7721

FRAME VIEWS

NOTE: THIS IS A

PLANNING LEVEL DRAWING.

THE STRUCTURE SHOWN IS SUBJECT TO ON-GOING DESIGN REVIEW AND UPDATE. EXPECT SOME CHANGES TO MATERIAL SIZES AND GENERAL DIMENSIONS. ONLY USE DRAWINGS PROVIDED WITH ENGINEERED STRUCTURES FOR CONSTRUCTION.

REFER TO ANCHOR AND FOOTING DOWNLOAD SHEETS FOR GENERAL INFORMATION ON BOTH ANCHOR ATTACHMENT AND TYPICAL FOOTING TYPES. ANCHOR ATTACHMENT AND FOOTING DESIGNS ARE SITE AND SITUATION SPECIFIC AND ARE INTEGRAL TO THE FINAL SHELTER DESIGN.

DO NOT POUR FOOTING OR INSTALL ANCHOR BOLTS WITHOUT JOB SPECIFIC ANCHOR AND FOOTING DESIGN DRAWINGS.

ALL POLYGON COLUMN ANCHORING SYSTEMS ARE OSHA COMPLIANT.

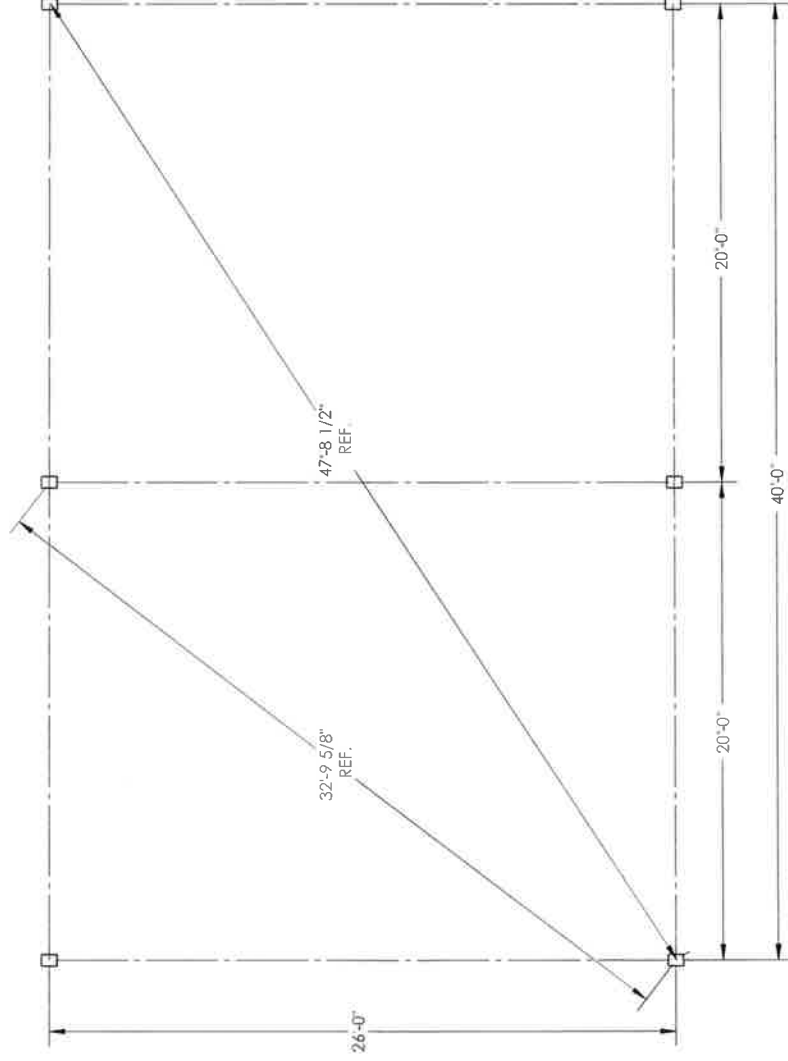

SHELTER MODEL:

**RECTANGLE 30X44
REK-30X44**

SCALE	REVISION	DATE
1:50	A	2/2/2011



PARK ARCHITECTURE

Designs and calculations of Polygon buildings are protected under copyright laws and patents and may not be used in the construction or design of a building that is not supplied by Polygon.

by **PORTERCORP**

PORTERCORP 4240 N. 138th AVE. HOLLAND, MI 49424
www.polygon.com 800-354-7721

SHEET

COLUMN LAYOUT

Copyright laws protect the style and visual appearance of the shelter; while patents may protect other parts of the design.

Kevin Boji

From: Glenda Schmidt [gschmidt@athcollc.com]
Sent: Monday, March 13, 2017 2:21 PM
To: kevinb@raytownparks.com
Subject: Shelter

Kevin,

A budget estimate for the Litchfield #1744-FS Laminated Curved Beam Gable End 20' x 44' shelter with tongue & groove roof decking, fiberglass shingles, steel columns, delivery, installation and the concrete slab is \$65,000.00.

Please contact us if we can be of any further assistance.

Glenda Schmidt
Sales Consultant
ATHCO, LLC
13500 W. 108th Street
Lenexa, KS 66215
Toll Free: 800-255-1102
Phone: 913-469-5600
Fax: 913-469-8134

Series 1700 Laminated Curved Beam Rectangulars

Architectural grade Glue-Laminated SYP members make up this popular series of shelters. Choose from a number of Gable-End or Dutch Hip-End Rectangular shelter sizes.

The Laminated Curved Beam Shelters come standard with glue-laminated SYP Curved Beams, SYP T&G Roof Decking and Pressure Treated Pine Columns.

Widths:

12', 14', 20', 24', 28', 30', 40', 50'

Lengths:

20', 28', 36', 44', 52', 60', 68'
(additional 8' Bays **ONLY**)

Options:

- Laminated or Steel Columns
- Handrails
- Metal Roof or Shingles
- BBQ Vented Roof
- Cupola



Model 1744-FS 20'X44' Laminated Curved Beam Gable End with 2"X6" SYP T&G Roof Decking, Fiberglass Shingles and Optional Steel Columns.



Laminated Curved Beam Ceiling with 2"X6" SYP T&G Roof Decking.



A full-length Barbeque Vent was added to this "L" shaped Laminated Curved Beam Shelter. Also shown with Optional Wood Handrails and Fiberglass Shingles.



Model 1745-MR29 40' X 60' Laminated Curved Beam Gable End Shelter with 2"X6" SYP T&G Roof Decking, 29 Gauge Max-Rib, Metal Roof and Steel Columns.



These drawings are for reference only and should not be used as construction details. They show the general features and rough dimensions of the structural features. Exact sizes, fasteners, materials, and foundations are determined by a licensed structural engineer upon request.

DRAWN BY
M.R.I.

DATE: 12-2-2017

Team Structure

DECLARATION
10'x44' Laminated Curved E
Q100114486
Q100114486

SHELTER

FOUNDATION NOTE:

All foundation design information should be considered as preliminary only. A local soils engineer shall be retained to design the foundation according to local conditions and codes. Final design of the footing/foundation is the responsibility of the general contractor/owner. SRP's analysis and design will pertain strictly to a pier foundation to adequately support structures requirements by others.

MISC. INFORMATION:

- Any unique design requirements should be mentioned up front during quoting or prior to purchasing sealed drawings.
- If available providing a soils report with the purchase of the sealed drawings may help to reduce footer requirements.
- SRP utilizes cylindrical footer designs as an industry standard. If specifically requested or special conditions require, SRP will provide spread footer designs.
- Epoxy analysis designs will require separate fees upon request.
- As a safe practice it is suggested to acquire sealed drawings prior to purchase of structures.

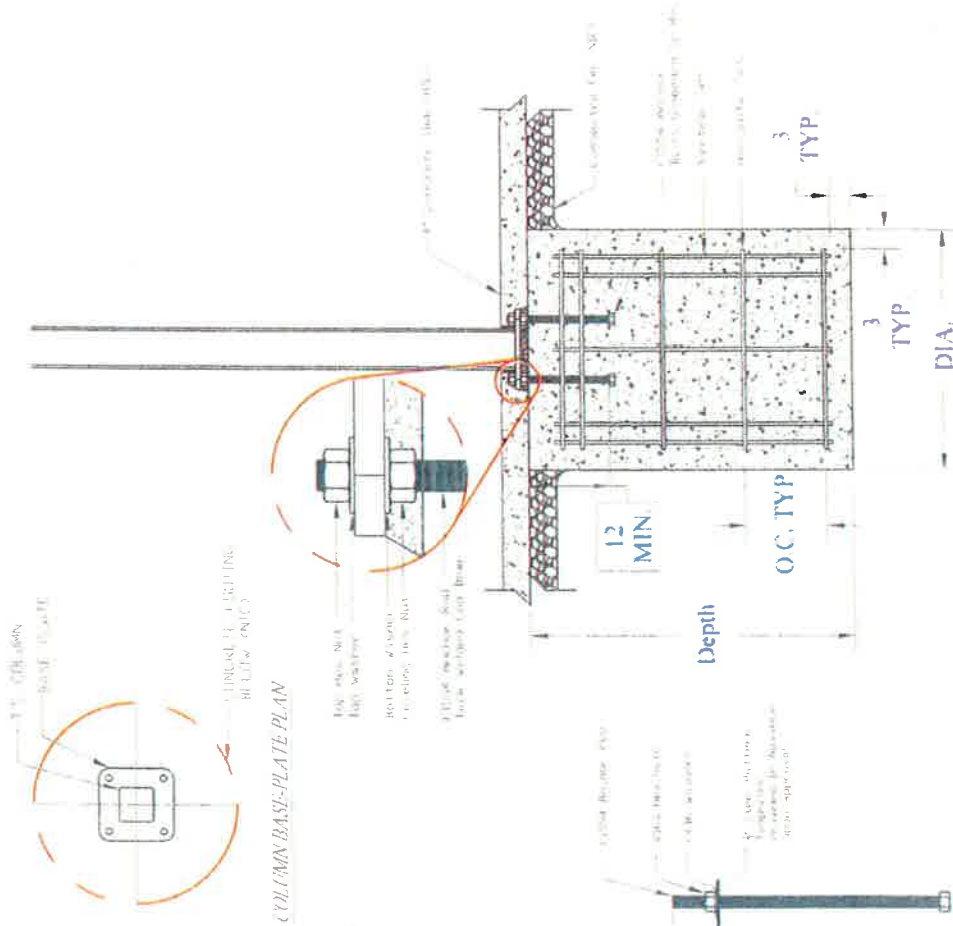

SHELTER

DESCRIPTION
20'x44' Laminated Curved Beam Structure

QUOTA
QU00114486

PROJECT NAME
#TBD

DATE
12/2/2017

DRAWN BY
M.R.L.

SCALE
NOT TO SCALE

SHEET
4 of 5

These drawings are for reference only and should not be used as construction details. They show the general character and rough dimensions of the structural features. Exact spacing, fasteners, materials, and foundations can be determined by a licensed structural engineer upon request.

S

1. ALL STRUCTURAL STEEL TUBING SHALL BE ASTM A-500 GRADE B-C.

1. ALL STRUCTURAL STEEL TUBING SHALL BE ASTM A-500 GRADE B-C.
2. ALL OTHER STEEL (PLATES, GUSSETS, ETC.) SHALL BE ASTM A-36.
3. ALL WELDING IS TO BE DONE IN ACCORDANCE WITH LATEST AWS STANDARDS. ALL WELDS ARE TO DEVELOP FULL STRENGTH OF COMPONENT PARTS. (E17081 ELECTRODES)
4. INCLUDED HARDWARE IS TO BE ASTM A-325 UNLESS OTHERWISE NOTED
5. PRODUCTION OF LAMINATED MATERIALS WILL BE IN ACCORDANCE WITH THE AMERICAN NATIONAL STANDARD ANSI A190.1
6. STRUCTURAL GLUED LAMINATED TIMBER
7. IF INCLUDED TONGUE & GROOVE WILL BE #1 Grade V-GROOVED SYP CONTAINING 15-20% MOISTURE CONTENT.
8. POWDER COATING PROCESS
9. STAGE 1 - Blast all steel to "Near White" condition to remove all surface rust and oil.
10. STAGE 2 - Remove dust from the blast process in stage 1.
11. STAGE 3 - This stage is the Electrostatic Application of Epoxy TGIC Powder Coating Zinc Rich Primer. Unlike any other shelter manufacturer, we are utilizing an actual TGIC Zinc Powder Coating Rich Primer. This stage 3 application is applied at 3 mils and has been salt spray tested for 4,000 + hours using the ASTM Method B117. (Note the 4,000 hours of salt spray testing is only with the Zinc Rich TGIC Powder Coat Primer and before the Stage 5. The 4,000 hours of salt spray testing is only with the Zinc Rich TGIC Powder Coating with the next stage
12. STAGE 4 - This process heats the steel and primer to ensure optimal adhesion with the next stage
13. STAGE 5 - This stage is the Electrostatic application of TGIC Top Powder Coat at 3 mils. This application, along with the Stage 4 Epoxy TGIC Powder Coating Zinc Rich Primer, produces a total of 6 mils of finished Powder Coating and has tested at 5,000+ hours using the ASTM Method B117. It is important to note that testing was discontinued at 5,000 hours
14. STAGE 6 - Curing Process: The final stage is to allow coated components the time to cure by cooling down.
15. IF INCLUDED METAL ROOFING IS TO BE ACRYLIC COATED GALVALUME® FLUOROPOLYMER (Kynar 500® PVDF resin-based). ALL METAL ROOFING WILL COME PRE-CUT UNLESS NOTED OTHERWISE. METAL ROOFING TRIMS WILL COME IN STANDARD SECTIONS AND WILL REQUIRE NOTCHING OR CUTTING IN FIELD

UNLESS REQUESTED THIS BUILDING HAS BEEN DESIGNED AS A FREE STANDING, OPEN STRUCTURE. IF WALLS ARE TO BE ADDED, OR IF THE BUILDING IS TO ADJOIN ANOTHER STRUCTURE, OR IF OTHER MODIFICATIONS ARE TO BE MADE, THE STRUCTURE MUST BE REENGINEERED PRIOR TO THESE MODIFICATIONS.

- BE REENGINEERED PRIOR TO THESE MODIFICATIONS.
IF SPECIFICATIONS ARE PROVIDED ALL DESIGNS ARE TO BE CONSIDERED TO BE AS EQUAL AND NOT AN EXACT
MATCH. THE COMPANY WILL CONFORM TO AAS MANUFACTURING METHODS AND MATERIALS AVAILABLE.

AS-ALL STE

- AS - ALL STEEL
- SF - STEEL FRAME
- DT - DUO-TOP
- T&G - TONGUE & GROOVE
- NIC - NOT IN CONTRACT
- O.C. - ON CENTER
- TYP. - TYPICAL

SHELTER

These drawings will be reference only and should not be used on construction details. They show the general character of rough dimensions at the structure of members. Exact dimensions, members, and foundations on the document is to be obtained from detail drawings which require

ADDITIONAL INFORMATION

174

(D. S. MATHUR) | **Integrated Curved Beam Structure**

1. **Introduction**

PHOTOGRAPH BY MICHAEL

0000114436 E 3:DMH

SCALE
NOT TO SCALE

5.015
17446

Little Blue Trace Trail Segment 8 South Bridge Connector

TAP 3430 (402)

March 2, 2017 Progress Meeting

Attendance

Rodney Riffle

Valerie Johnson

Daisy Dixon

Ed Andres

Kenneth Radmacher

1. Schedule Update

a. Trail

- i. Base rock installation this week from approximately Sta 20+00 to Sta 39+00
- ii. Concrete to be poured next week on above mentioned location

b. Bridge

- i. Finish north bent this week
- ii. Start south bent next week
- iii. Bridge is two to three weeks away from being delivered

2. MODOT Requirements

a. Permits – On hand

b. Postings – No Change

c. Material Testing

- i. Sub grade testing complete
- ii. Base rock to be proof rolled with 20 ton twin axle prior to concrete pour

d. Buy American – Rebar and Bridge

e. Delivery Slips – Continue to come in

f. DBE

- i. Rebar next week
- ii. Bridge bolting in two to three weeks

g. Change Orders

3. Utilities

- a. Electrical service for pump – Repaired
 - b. AT&T pole relocation – No movement yet
- 4. Outstanding Issues
 - a. Possible CMP quantity change due to differing pipe size and length
 - b. Possible additional riprap quantities
- 5. Next Meeting Date March 16, 2017 @11:30 – North end of parking lot in Little Blue Trace Park